



Canterbury Crescent, Brixton, SW9

2 bedroom flat - purpose built for sale

£650,000

Freehold

Property Details

The apartment comprises a good size, semi-open plan reception room, with large bay sash windows flooding the room with natural light, perfect for relaxing and entertaining guests. Adjacent is the stylish eat-in kitchen with integrated appliances. Two well-proportioned double bedrooms are located at the back of the building, the master bedroom has a stylishly finished en-suite bathroom and it is evident that the entire flat has been well cared for by the current owners. The roof terrace adds an appeal to this flat that many others in the building cannot offer. South-West facing means the space is a sun-trap into the later hours of the day and absolutely perfect for entertaining guests or enjoying an evening drink as the sun sinks away into the distance. The current owners have transformed the space into a professionally landscaped haven, tucked away quietly overlooking the surrounding area from a private and peaceful position.

Features

- Two double bedrooms
- Victorian mansion block
- South-West facing, private roof terrace
- Double-glazing and refurbished interior
- Bright and tastefully finished
- Situated in the heart of Brixton
- A rich variety of local amenities
- A short walk to Brixton Village and the tube station

Council tax band D

EPC rating D (63)



Canterbury Crescent, Brixton, SW9



Canterbury Crescent

2 Bedroom Flat

Approx internal area:

781 sqft 73 sqm

(EXCLUDING EAVES STORAGE)
EAVES STORAGE 6.74 SQ.M / 73 SQ.FT
INCLUSIVE TOTAL AREA 79.74 SQ.M / 858 SQ.FT

While we do try our very best,
floor plans are produced as a
guide only and we take no
responsibility for the precise
accuracy with which any
property is represented

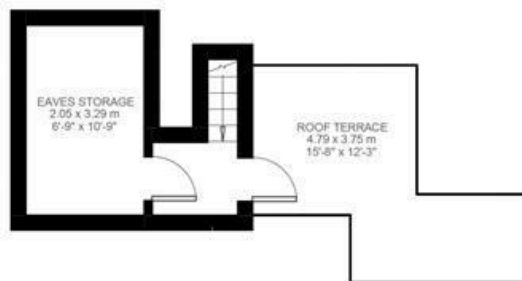

Fourth Floor



Third Floor



Canterbury Crescent, Brixton, SW9

